

WOHNBAU ASTEN IPFBACH - AREAL C

HAUS 2 - 1. OG - WOHNUNG 6



Norbert Haderer Ziviltechniker GmbH

4020 Linz Annagasse 2

fon 0732/78 1028 fax -14

e-mail office@haderer.or.at

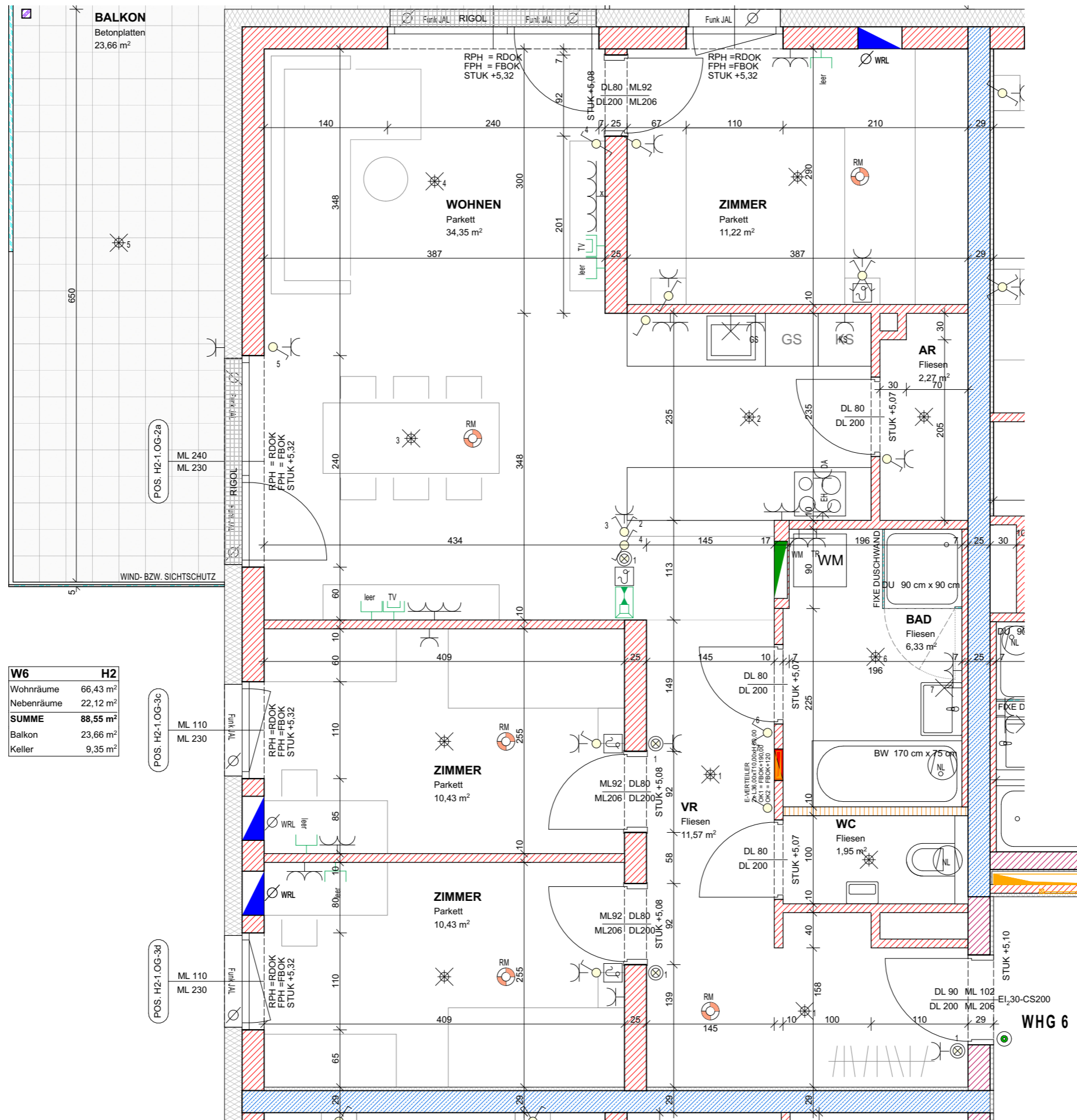

W6	H2
Wohnräume	66,43 m ²
Nebenräume	22,12 m ²
SUMME	88,55 m²
Balkon	23,66 m ²
Keller	9,35 m ²

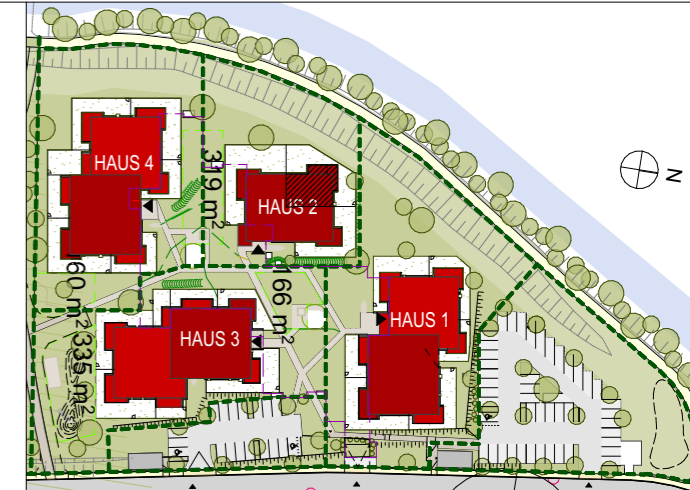

LAGEPLAN

ELEKTROLEGENDE

	Aus-Schalter		Lüfter
	Serien-Schalter		Motorantrieb
	Wechsel-Schalter		WRL-Regler
	Doppel-Wechsel-Schalter		Zutrittskontrolle
	Kreuz-Schalter		Leerrohr
	Dimmer		Rauchmelder
	Zeit-Schalter		Türöffner
	Klingel-Taster		Sprechanlage (Innen)
	Licht-Taster		Sprechanlage (Aussen)
	Unterverteiler		Telefon-Dose
	Steckdose 1fach		TV-Dose
	Steckdose 2fach		Licht-Auslass (Decke)
	Steckdose 3fach		Licht-Auslass (Wand)
	Steckdose geschalten		Licht-Auslass (Direkt-Wand)
	CEE 5pol		Wandleuchte
	230V-Auslass		Deckenleuchte
	400V-Auslass		Scheinwerfer
	Raumthermostat		FR-Balken 1/36 oder 1/58

ALLGEMEINE LEGENDE

	Stahlbetonwand		Schallschutzziegel
	Ziegelwand		Glas
	SBZ Ziegelmantelsteine		Stahlsäule
	Gipskartonwand		Wohnraumlüftung
	Wärmedämmung		FBH-Verteiler

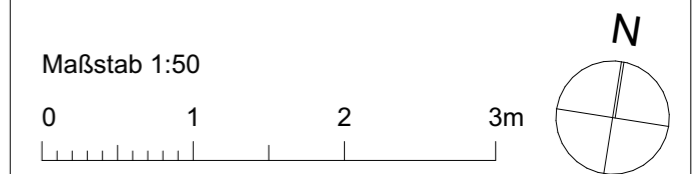

Gezeichnet CKR/JAK

Datum 11.10.2022

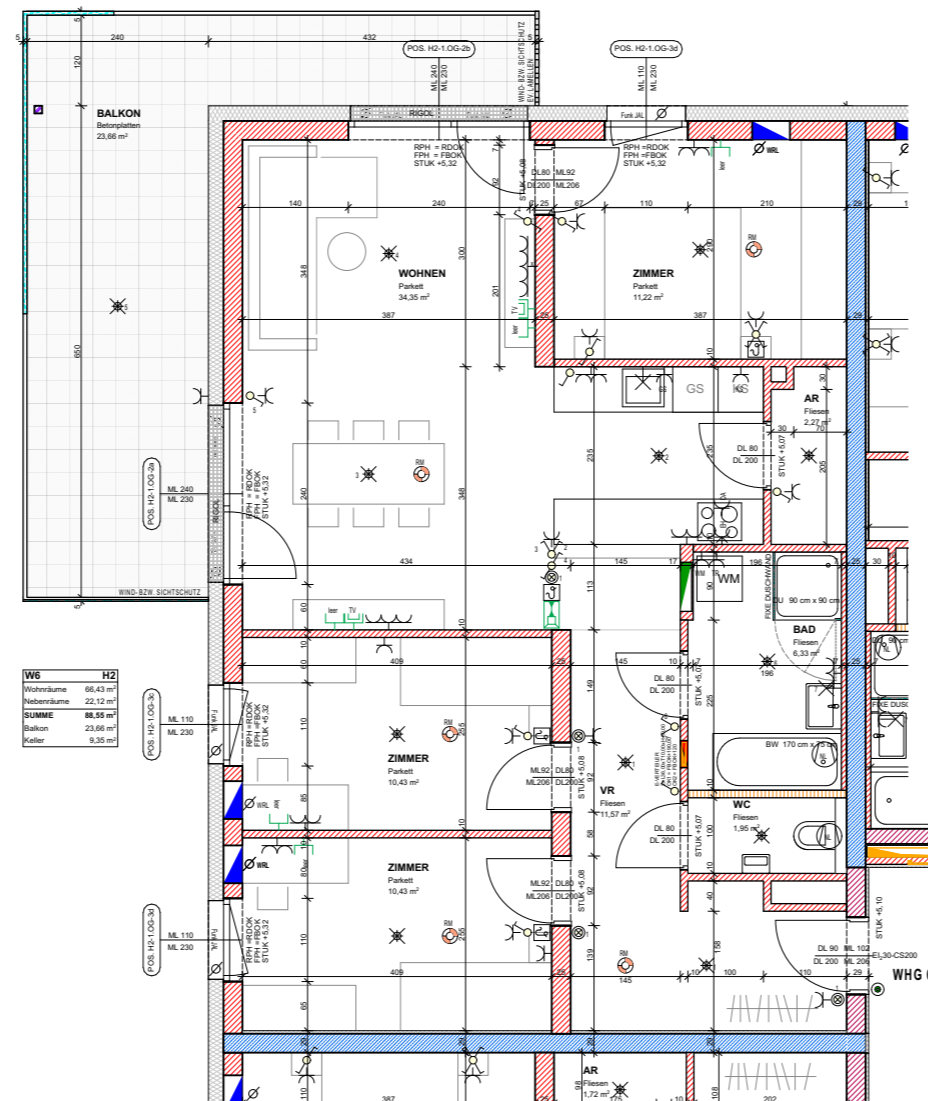



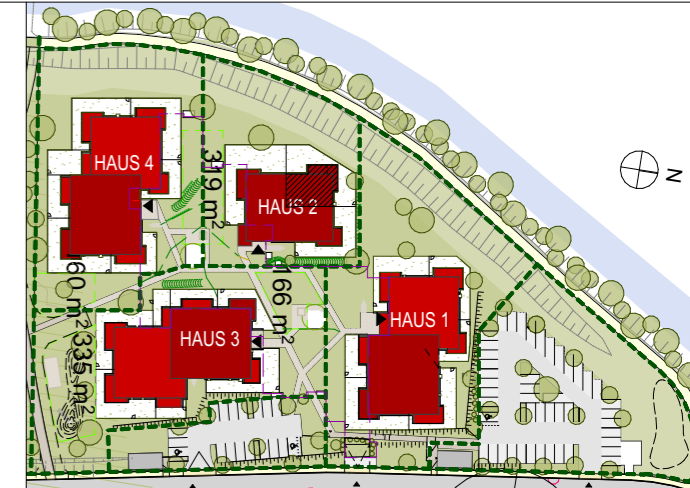









WG	HZ
Nebensäume	66.43 m²
Nebensäume	22.12 m²
SUMME	88.55 m²
Balkon	23.66 m²
Keller	9.35 m²

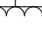











LAGEPLAN

ELEKTROLEGENDE

	Aus-Schalter		Lüfter
	Serien-Schalter		Motorantrieb
	Wechsel-Schalter		WRL-Regler
	Doppel-Wechsel-Schalter		Zutrittskontrolle
	Kreuz-Schalter		Leerrohr
	Dimmer		Rauchmelder
	Zeit-Schalter		Türöffner
	Klingel-Taster		Sprechanlage (Innen)
	Licht-Taster		Sprechanlage (Aussen)
	Unterverteiler		Telefon-Dose
	Deckendose		TV-Dose
	Steckdose 1fach		Licht-Auslass (Decke)
	Steckdose 2fach		Licht-Auslass (Wand)
	Steckdose 3fach		Licht-Auslass (Direkt-Wand)
	Steckdose geschalten		Wandleuchte
	CEE 5pol		Deckenleuchte
	230V-Auslass		Scheinwerfer
	400V-Auslass		FR-Balken 1/36 oder 1/58
	Raumthermostat		

ALLGEMEINE LEGENDE

	Stahlbetonwand		Schallschutzziegel
	Ziegelwand		Glas
	SBZ Ziegelmantelsteine		Stahlsäule
	Gipskartonwand		Wohnraumlüftung
	Wärmedämmung		FBH-Verteiler

Maßstab 1:100

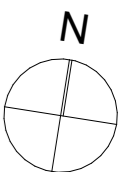

Gezeichnet **CKR/JAK**

Datum **11.10.2022**