

Wohnanlage "Zwei Eichen"

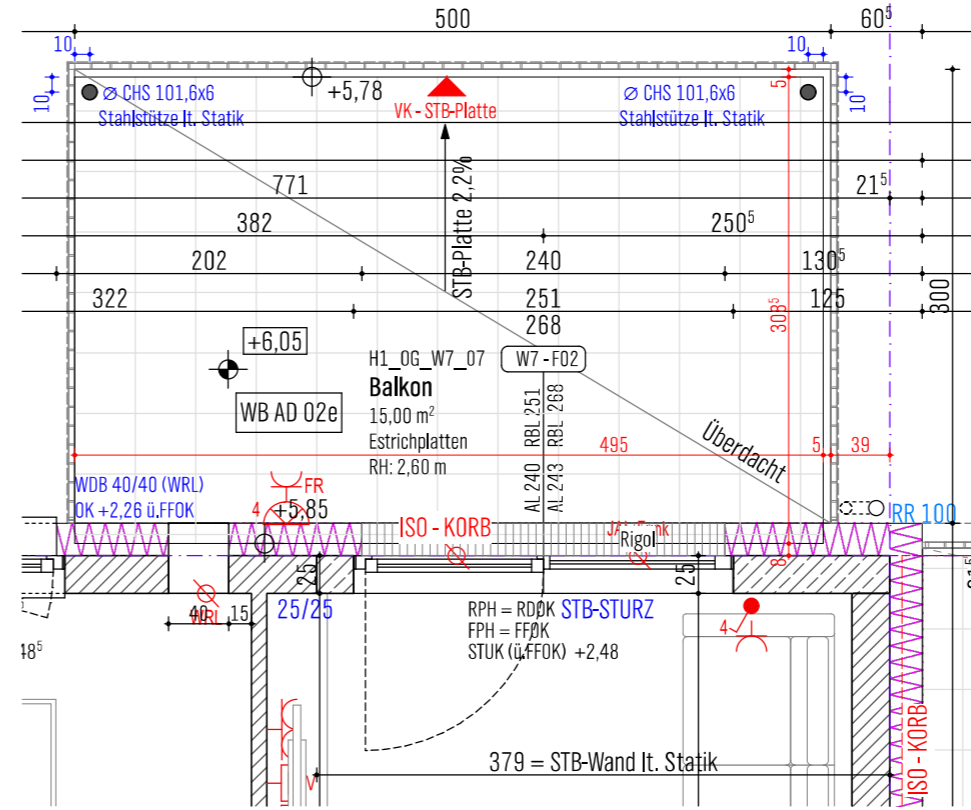

| H1/W7 | | |
|--------------|------------|-----------------|
| H1_OG_W7_01 | Vorraum | 4,71 |
| H1_OG_W7_02 | AR | 1,73 |
| H1_OG_W7_03 | Wohnraum | 32,08 |
| H1_OG_W7_04 | Zimmer | 15,59 |
| H1_OG_W7_05 | Bad | 7,02 |
| H1_OG_W7_06 | WC | 1,84 |
| | | 62,97 m² |
| H1/W7 Balkon | | |
| H1_OG_W7_07 | Balkon | 15,00 |
| | | 15,00 m² |
| H1/W7 Keller | | |
| H1_UG_W7 | K.A. H1/W7 | 5,04 |
| | | 5,04 m² |

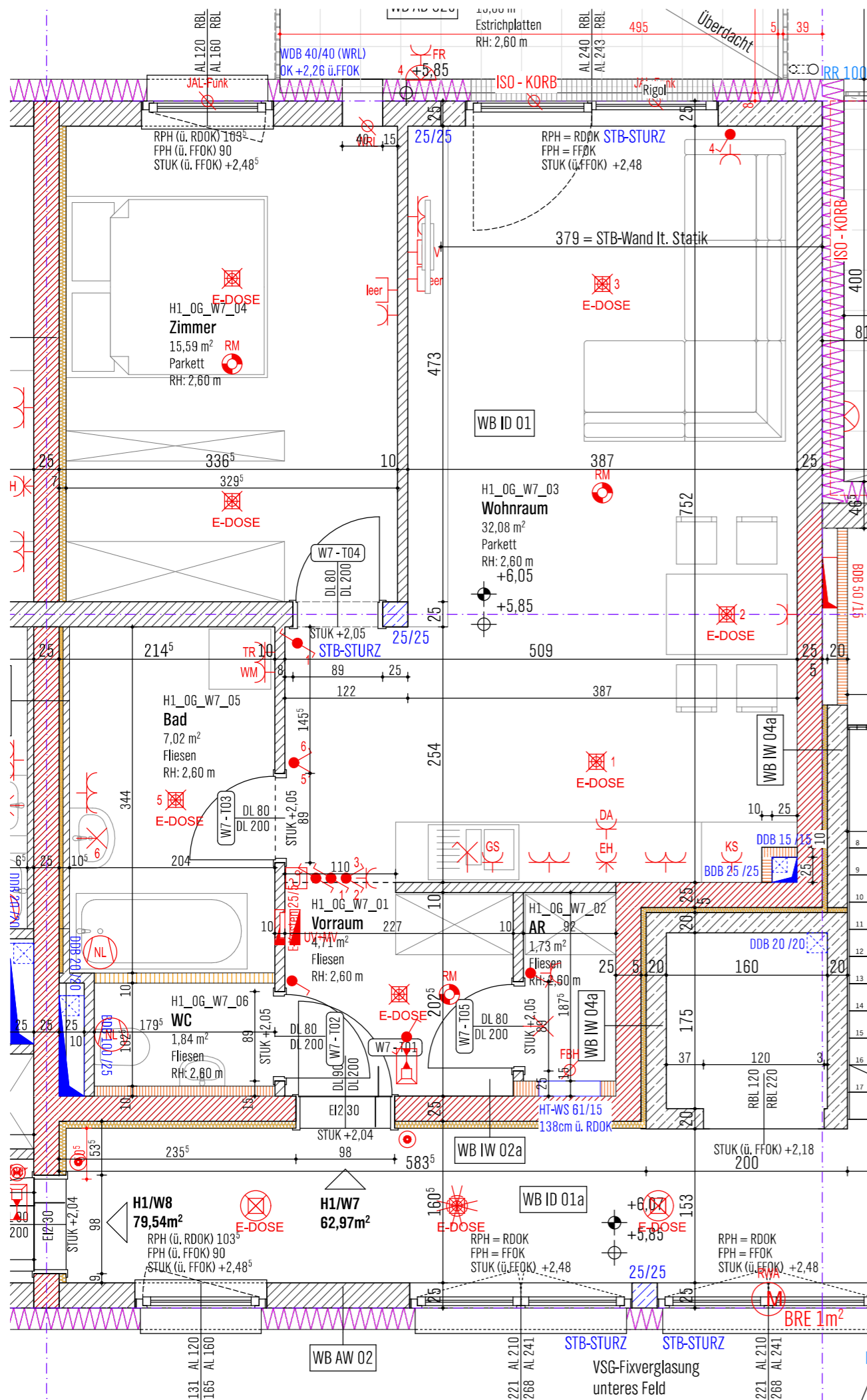
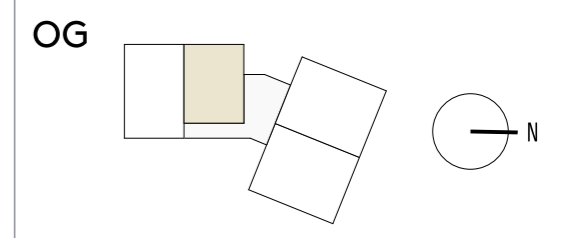

WSG
Gemeinnützige Wohn- und Siedlergemeinschaft
regGenmbH
Goethestraße 2, 4020 Linz, +43 732 664471



332_7 13.11.2020

1:50 Haus 1 - Wohnung 7

TP3 Architekten ZT GmbH
Hofberg 10/2, A-4020 Linz
+43 732 773097
architekten@tp3.at